

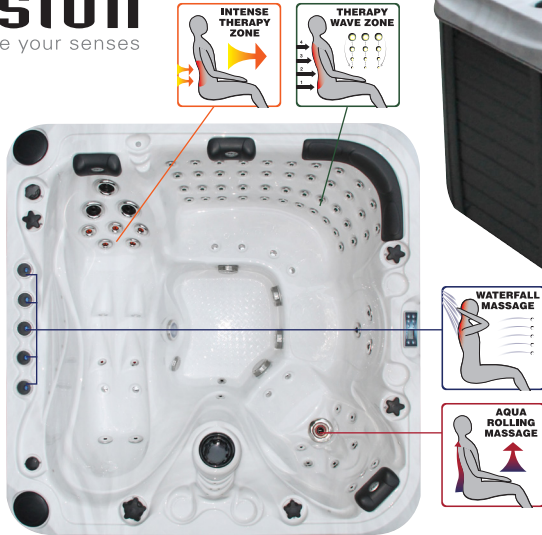

THE FELICITY

PASSION SPAS EXCLUSIVE COLLECTION

passion
spas | love your senses

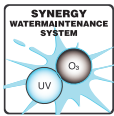

SPECIFICATIONS/GENERAL

Dimensions LxWxH.....	213x213x91 cm
Number of Seats.....	4
Number of Loungers.....	1
Capacity in Liter.....	1490
Dry Weight in kg.....	390
Full Weight in kg.....	1880
Shell Material.....	Aristech® Acrylic with Vinylester and Polyester
Synthetic Maintenance Free Cabinet.....	Standard
Removable Side Panels.....	4
Durable Support System.....	Synthetic
Everlast™ Full Floor Support Material.....	Polyester
High Density Urethane Insulation.....	Standard
Cup Holders.....	?

WATER SYSTEM

Total jets.....	78
Water Jets, Stainless Steel.....	70
Air Injector Jets.....	8
Air Control Valve.....	2
Filters / Surface.....	(1) 50 Square Feet
Top Access Skim Filter.....	High-Volume Vortex Skimmer
Floor Drain.....	1
External Drain.....	1
Hi Flow Suctions.....	4
Water Diverter Valve.....	1
5" Massage Jets, Directional, Rotational and Pulsational.....	4
3" Directional Jets.....	10
2" Directional Jets.....	36
Ozone Jets.....	1

SPECIAL FEATURES

Soft Air Massage System.....	Standard
Molded Headrest Soft Pillows with LED Light.....	4
StarBrite Interior LED Light System.....	Standard
Cascade Creek Water Fall.....	1
Exterior Corner LED Lighting.....	2
Aromatherapy System.....	Standard
Ozone Sanitation System.....	Standard
UV Synergy System.....	Standard
Ultra Efficient Dual-Wrap Cabinet Insulation.....	Standard
5/4 Ultra Efficient Walk-On Cover.....	Optional
Wifi Ready.....	Standard

PUMP INFORMATION

Massage Pump 1: LX LP300.....	2,2 kW
Massage Pump 2: LX LP300.....	2,2 kW
Filtration Pump: LX WTC50M.....	250W
Air Pump: LX AP300.....	300W

ELECTRICAL SYSTEM

Voltage.....	230/380 V
Amperage.....	230V - 20A / 380V - 16A
Full Flow Electric Heater.....	3 kW
Control System.....	Balboa BP600
Light (18 x Multi Color LED).....	Standard
Electronic Topside Control.....	Balboa TP600